

# **THE COUNCIL OF THE BOROUGH OF MILTON KEYNES (CONNIBURROW) (OFF-STREET LIMITED WAITING AND PERMIT PARKING PLACES) ORDER 2012**

The Council of the Borough of Milton Keynes ("the Council") in exercise of its powers under Sections 1(1), 2(1) and (2), 4(1), 32(1), 35, 35A, 53 ("the Act of 1984") and of all other enabling powers, and after consultation with the chief officer of police in accordance with Part III of Schedule 9 to the Act of 1984, hereby makes the following Order:

## **PART 1**

### **IMPLEMENTATION, CITATION AND DEFINITIONS**

1. This Order shall come into operation on 7 September 2012 and may be cited as "The Council of the Borough of Milton Keynes (Conniburrow) (Off-Street Limited Waiting and Permit Parking Places) Order 2012".
2. In this Order, except where the context otherwise requires, the following expressions have the meanings respectively assigned to them:-

"business" means any business or organisation as named or numbered in any street described in Schedule 3B of this Order;

"business permit" means a permit issued in accordance with Part 8 to this Order;

"carer" means a person who provides care to those in need of medical, nursing or personal assistance and employed either by a public service body or an officially registered company;

"carer permit" means a permit issued in accordance with Part 7 to this Order;

"Civil Enforcement Officer" has the same meaning as in Section 76 of the Traffic Management Act of 2004;

"Council" means The Council of the Borough of Milton Keynes;

"delivering" and "collecting" in relation to any goods includes checking the goods for the purpose of their delivery or collection;

"disabled persons' badge" has the same meaning as in the Local Authorities' Traffic Orders (Exemptions for Disabled Persons) (England) Regulations 2000;

"driver" in relation to a vehicle waiting in a parking place, means the person driving the vehicle at the time it was left in the parking place;

"dual purpose vehicle" has the same meaning as in the Road Vehicles (Construction and Use) Regulations 1986;

"goods" includes postal packets of any description, cash or other valuable securities;

"goods vehicle" means a motor vehicle which is constructed or adapted for the carriage of goods of any description and which does not exceed 3.5 tonnes gross laden weight;

"moped" means a two or three wheel vehicle fitted with an engine having a cylinder capacity not exceeding 50 cm<sup>3</sup> if of the internal combustion type and a maximum design speed of not more than 45 kilometres per hour;

"motor cycle" has the same meaning as in Section 136 of the Act of 1984;

"passenger vehicle" means a motor vehicle (other than a motor cycle or invalid carriage) constructed solely for the carriage of passengers and their effects and adapted to carry not more than twelve passengers exclusive of the driver, and not drawing a trailer;

"permit holder" means a person to whom a permit has been issued under the provisions of Parts 5, 6, 7 and 8 of this Order;

"permit period" means such period as stated in Schedule 4 to this Order;

"postal packets" has the same meaning as in Section 125 of the Postal Services Act 2000;

"prescribed hours" means between those hours stated in Schedules 1, 2A and 3A of this Order;

"resident" means a person whose usual place of residence is a property with a postal address in any street described in Schedule 2B of this Order;

"residents permit" means a permit issued under the provisions of Part 5 of this Order;

"residents visitors permit" means a permit issued under the provisions of Part 6 of this Order;

"restricted road" means a road which is subject to parking and waiting restrictions;

"road" means a highway and any other road to which the public has access;

"statutory undertaker" has the same meaning as in Section 329 of the Highways Act 1980;

"traffic sign" means a sign of any size, colour and type prescribed or authorised under, or having effect as though prescribed or authorised under, Section 64 of the Act of 1984;

"unused amount of time" in relation to a permit means that part of the permit period that remains unused at the time of receipt by the Council of an application for a replacement permit.

3. Any reference in this Order to any enactment shall be construed as a reference to that enactment as amended by any subsequent enactment.
4. The plans annexed to this Order identify the areas subject to this Order, provided that where there is any inconsistency between the plans and the Schedules it is the wording of the Schedules which shall prevail.

## PART 2

### OFF-STREET PARKING PLACES

5. (1) Each area which is specified in Schedules 1, 2A and 3A in this Order is designated as an off-street parking place during the prescribed hours detailed in those Schedules and subject to the provisions to this Part of this Order as an off-street parking place for passenger vehicles, dual purpose vehicles, goods vehicles, mopeds and motor cycles.
  - (2) Nothing in paragraph (1) of this Article shall apply so as to permit a trailer, whether or not attached to a vehicle, to park at any time in any off-street parking place.
  - (3) No person shall park any street trading vendors vehicle in an off-street parking place or use any such vehicle while it is in such a parking place, in connection with the sale of any article to any person in or near the parking place or in connection with the selling or offering for hire of his skill or services, provided nothing in this Article:-
    - (a) Shall prevent the sale of goods from a vehicle if the vehicle is of a class specified in paragraph (1) of this Article and if the goods are immediately delivered at or taken into premises adjacent to the vehicle from which the sale is effected; or
    - (b) Shall apply if the person has obtained the written consent of the Council before doing so.
6. The driver of a vehicle shall not permit that vehicle to wait in an off-street parking place unless the vehicle is licensed in pursuance of the provisions of the Vehicle Excise and Registration Act 1994, and unless there is in relation to the use of the vehicle by the driver such a policy of insurance as complies with the requirements of Part VI of the Road Traffic Act 1988.
7. Where in an off-street parking place signs are erected or surface markings are laid for the purpose of indicating the entrance or exit from the parking place, or indicating that a vehicle using the parking place shall proceed in a specified direction within the parking place, no vehicle shall be driven so as to enter the parking place otherwise than by an entrance, or leave the parking place otherwise than by an exit, so indicated or in a direction other than so specified.
8. The driver of a vehicle using an off-street parking place shall not sound any horn or other similar instrument except when about to change position of the vehicle in or to depart from that parking place.
9. When a notice has been attached to a vehicle in accordance with any provisions of this Order no person other than a person authorised by the Council in that behalf or the driver or a person authorised by the driver in that behalf shall remove the notice from the vehicle.
10. Any vehicle present in an off-street parking place specified in Schedules 1, 2A and 3A hereto at the commencement of the prescribed hours of operation of any restrictions imposed by this Order shall be deemed to have been left in that parking place at the commencement of that period of operation of that parking place.
11. (1) The limits of each off-street parking place and of every off-street parking space within an off-street parking place and the limits of any access way shall be indicated by the appropriate traffic signs.
  - (2) Any vehicle standing in an off-street parking place shall stand wholly within the limits

so marked or, if the length of the vehicle precludes the vehicle being positioned in that manner, so that the longitudinal axis of the vehicle is parallel to the edge of the carriageway nearest to the vehicle;

- (3) Any vehicle standing in an off-street parking place shall stand wholly within the limits so marked so that no part of the vehicle obstructs any access way other than from or to the premises referred to in paragraph (4)(h) of Article 16.
12. The driver of a vehicle using an off-street parking place shall stop the engine as soon as the vehicle is in position and in the parking place, and shall not start the engine of the vehicle except when about to change position of the vehicle in or to depart from the parking place.
13. Nothing in Article 5 of this Order shall render it a contravention of this Order to cause or permit a disabled person's vehicle which displays a disabled person's badge in the relevant position in accordance with Article 14 hereof to park in an off-street parking place outside of the prescribed hours.
14. For the purposes of this Order a vehicle shall be regarded as displaying a disabled person's badge in the relevant position under the Disabled Persons (Badges for Motor Vehicles) (England) Regulations 2000 if:
  - (1) The badge is exhibited on the dashboard or facia of the vehicle so that the front of the badge is clearly legible from the outside of the vehicle; or
  - (2) Where the vehicle is not fitted with a dashboard or facia, the badge is exhibited in a conspicuous position on the vehicle so that the front of the badge is clearly legible from the outside of the vehicle.
15.
  - (1) A police officer in uniform, a traffic warden or a Civil Enforcement Officer may in case of emergency move or cause to be moved any vehicle left in an off-street parking place to any place he thinks fit.
  - (2) Any person authorised to remove a vehicle or alter its position by virtue of paragraph (1) of this Article may do so by towing or driving the vehicle or in such manner as he may think necessary and may take such measures in relation to the vehicle as he may think necessary to enable him to remove it or alter its position as the case may be.
16. Nothing in this Part of this Order shall render it a contravention of this Order to cause or permit a vehicle to park during the prescribed hours in an off-street parking place specified in Schedules 1, 2A and 3A for so long as may be necessary:-
  - (1) When the person in control of the vehicle is required by law to stop or is obliged to stop in order to avoid an accident or is prevented from proceeding by circumstances outside his control;
  - (2) To enable a person to board or alight from the vehicle;
  - (3) To enable goods to be loaded or unloaded from the vehicle;
  - (4) To enable the vehicle if it cannot reasonably be used for such purpose in any other road to be used in connection with any of the following:
    - (a) building, industrial or demolition operations;

- (b) the removal of any obstruction to traffic;
- (c) the laying, erection or repair of any sewer, main, pipe or apparatus for the supply of gas, water, electricity, or any telecommunication system defined by the Telecommunications Act 1984;
- (d) use in the service of any undertaker, the Environment Agency or any public authority in pursuance of statutory powers or duties;
- (e) use for police, fire brigade, ambulance or military purposes;
- (f) use for the purpose of delivering or collecting postal packets as defined by section 125 of the Post Services Act 2000;
- (g) the vehicle being specially constructed or adapted for the delivery or collection of money or valuable securities to be used for those purposes in relation to premises in the vicinity;
- (h) the removal of furniture or household effects to or from a shop, office, depository or dwelling house adjacent to the off-street parking place.

17. (1) Any person authorised by the Council may suspend the use of an off-street parking place or any part thereof whenever and for such duration as the Council considers such suspension reasonably necessary:

- (a) for the purpose of facilitating the movement of traffic or promoting its safety;
- (b) for the purpose of building, industrial or demolition operations;
- (c) for the purpose of the maintenance, improvement or reconstruction of the parking place;
- (d) for the purpose of the laying, erection or repair of any sewer, main, pipe or apparatus for the supply of gas, water, electricity or any telecommunication system defined by the Telecommunications Act 1984;
- (e) for the convenience of occupiers of premises adjacent to the off-street parking place on any occasion of the removal of furniture or household effects to or from a shop, office, depository or dwelling house;
- (f) on any occasion on which it is likely by reason of some special attraction that any road will be thronged or obstructed;
- (g) for the convenience of occupiers of premises adjacent to the off-street parking place as times of wedding or funerals, or on other special occasions;
- (h) for the placing of recycling bins.

(2) A police officer in uniform, traffic warden or Civil Enforcement Officer may suspend

for not longer than twenty-four hours the use of an off-street parking place or any part thereof whenever he considers such suspension reasonably necessary for the purpose of facilitating the movement of traffic or promoting its safety.

- (3) Without prejudice and in addition to all other enabling powers the Council shall have the power from time to time as it deems appropriate to close or suspend for as long as it considers necessary the use of any off-street parking place for the purpose of enabling such parking place to be used by exhibition or public information vehicles of official or quasi official authorities or bodies whose contents are intended to be and are made available for inspection by and for the public without any charge of any kind being made to the public.
18. On the suspension of use of an off-street parking place or any part thereof in accordance with the provisions of Article 17 of this Order the person authorising or causing such suspension shall, if the use of the whole or of any part of the parking place is suspended, place or cause to be placed in or adjacent to that parking place a traffic sign indicating that the use of the parking place is suspended and that waiting, or waiting and loading by vehicles is prohibited.
  19.
    - (1) Save as in paragraph (2) of this Article no person shall cause or permit a vehicle to be left in an off-street parking place or part thereof during any period when there is in or adjacent to that parking place or part thereof a traffic sign placed in pursuance of Article 18 of this Order that the whole or part of that parking place has been suspended.
    - (2) Subject to the overriding requirement that the person in control of the vehicle shall move it on the instruction of a police officer in uniform or traffic warden whenever such moving shall be necessary for the purpose of preventing obstruction, nothing in paragraph (1) of this Article shall render it a contravention of this Order to cause or permit any vehicle being used for fire brigade, ambulance, police or military purposes or any vehicle being used for any purpose or eventuality specified in paragraph (1) of Article 17 of this Order to be left in the off-street parking place or part thereof during any such period when the use thereof has been suspended, or to any other vehicle so left if that vehicle is left with the permission of a police officer in uniform, a traffic warden or a Civil Enforcement Officer.
  20.
    - (1) No person shall use a vehicle, whilst it is in an off-street parking place, in connection with the selling or offering for hire of his skill or services.
    - (2) No person shall use any part of an off-street parking place or any vehicle left in an off-street parking place:
      - (a) for sleeping, camping or cooking;
      - (b) for the erection of any tent, booth, stand, building or other structure without express permission from the Council;
      - (c) for lighting of a fire;
      - (d) for distributing leaflets/pamphlets/fliers or literature by hand or by leaving on a vehicle without express permission from the Council;
      - (e) for selling or trading without express permission from the Council;

- (f) for behaviour of a threatening, abusive or annoying nature including the playing of ball games.

### **PART 3**

#### **WAITING RESTRICTIONS**

21. No person shall except with the permission or under the direction of a police officer in uniform, a traffic warden or a Civil Enforcement Officer cause or permit any vehicle to wait in the parking places specified in Schedule 1 hereto between the prescribed hours and days of operation:-
- (1) for longer than 30 minutes;
  - (2) If a period less than 1 hour has elapsed since the termination during the said hours of the last period of waiting (if any) by that vehicle in the same restricted parking place.
22. A vehicle which is present in any parking place specified in Schedules 1, 2A and 3A hereto at the commencement of the hours of operation of any restrictions imposed by this Order shall be deemed to have been left in that parking place at the commencement of that period of operation of the restriction in question.

### **PART 4**

#### **RESIDENTS' PERMIT PARKING PLACES, RESIDENTS' VISITORS PERMIT PARKING PLACES, CARERS PERMIT PARKING PLACES AND BUSINESS PERMIT PARKING PLACES**

23. (1) Each of the parking places specified in Schedules 2A and 3A to this Order is authorised to be used during the prescribed hours, subject to provisions to this Part of this Order, as a parking place for a passenger vehicle, dual purpose vehicle, goods vehicle, moped or motor cycle which displays in the relevant position:-
- (a) a resident's permit;
  - (b) a resident's visitor's permit;
  - (c) a carer's permit.
  - (d) a business permit.
- (2) For the purpose of this Order a vehicle shall be regarded as displaying a residents' parking permit, residents visitors parking permit, carers parking permit or business parking permit in the relevant position if:-
- (a) the residents parking permit, residents visitors parking permit, carers parking permit or business parking permit is exhibited in a conspicuous position on the vehicle's front windscreen so that the wording on the front of the permit is clearly legible from outside the vehicle; or
  - (b) the residents parking permit, residents visitors parking permit, carers parking permit or business parking permit is exhibited in a conspicuous position on the

dashboard of the vehicle so that the wording on the front of the permit is clearly legible from outside the vehicle.

- (3) Where a residents parking permit, residents visitors parking permit, carers parking permit or business parking permit has been displayed on a vehicle in accordance with the provisions of parts (a) and (b) of paragraph (2) above, no person, not being the driver of the vehicle, shall remove the permit from the vehicle unless authorised to do so by the driver of the vehicle.

## **PART 5**

### **RESIDENT'S PERMITS**

24. (1) Any resident over the age of 17, who is the user of a passenger vehicle, dual purpose vehicle, goods vehicle, moped or motor cycle, may apply to the Council for the issue of a residents permit for use by the user of such vehicle other than a person to whom such vehicle has been let for hire or reward;
- (2) Any such application shall be made on a form issued by the Council and shall include the information required by such form and shall be accompanied by a remittance for such charge as is specified in Schedule 4;
- (3) On receipt of an application made under the foregoing provisions of this Article the Council upon being satisfied that the applicant meets the requirements of this Article, shall issue to that applicant one residents permit, provided that, subject to the provisions of Article 26 of this Order, such a residents permit would not be valid for any period during which any other residents permit issued to that resident would be valid;
- (4) The Council may at any time require an applicant for a residents permit to produce to an officer of the Council such evidence in respect of an application for a resident's permit made to them as they may reasonably require to verify any information given to them.
25. (1) The holder of a residents permit may surrender that residents permit to the Council at any time and shall surrender a residents permit to the Council on occurrence of any of the events, as are set out in paragraph (3) of this Article.
- (2) The Council may by notice in writing served on the holder of a residents permit by sending the same by recorded delivery service to the address shown by that person on the application for the residents permit or at any other address believed to be that person's residence, withdraw a resident's permit if it appears to the Council that any one of the events in respect of a residents permit as set out in Paragraph 3 of this Article has occurred and the holder of the residents permit shall surrender the residents permit to the Council within 48 hours of the service of such notice.
- (3) The events referred to in the foregoing provisions of this Article are:
- (a) The holder of the residents permit ceasing to be an eligible resident;
- (b) The holder of the residents permit ceasing to be the user of the vehicle in respect of which the permit was issued;



- (c) The vehicle in respect of which a residents permit was issued being adapted or used in a manner that is not a vehicle of the class specified in Article 24(1) of this Order;
  - (d) The issue of a replacement resident's permit by the Council under the provisions of Article 26(1) of this Order;
  - (e) The residents permit having been obtained by fraudulent means.
- (4) A residents permit shall cease to be valid at the end of the permit period specified thereon or on the occurrence of any one of the events set out in paragraph (3) of this Article, whichever is the earlier.
- (5) The Council may at any time require the holder of a residents permit to produce to an officer of the Council such evidence in respect of any permit issued by them as they may reasonably require.
26. (1) If a residents permit is mutilated or defaced or the figures or particulars on it have become illegible or the colour of the residents permit has become altered by fading or otherwise, the holder of the residents permit shall surrender it to the Council and may apply to the Council for the issue to him of a replacement residents permit and the Council, upon receipt of the residents permit if such receipt is accompanied by an application for a replacement residents permit and by a remittance for such charge as specified in Schedule 4, shall issue a replacement resident's permit so marked.
- (2) If a residents permit is lost or destroyed, the holder of the residents permit may apply to the Council for the issue to him of a replacement residents permit and the Council, upon being satisfied as to such loss or destruction, and upon receipt by the Council of an application for a replacement residents permit accompanied by a remittance for such charge as is specified in Schedule 4, shall issue a replacement resident's permit so marked.
- (3) The provisions of this Order shall apply to a replacement residents permit and an applicant for a replacement residents permit as if it were a residents permit, or as the case may be, an application therefore.
27. A residents permit shall be in writing and shall include the following particulars:
- (1) The registration mark of the vehicle in respect of which the residents permit has been issued;
  - (2) The date of expiry being the last day of the permit period;
  - (3) An authentication that the residents permit has been issued by the Council.
28. A residents permit shall only be valid for the duration of the permit period.
29. (1) The applicant for a residents permit who surrenders a residents permit to the Council before the permit becomes valid shall be entitled to a refund of the charge paid in respect of the issue thereof;

- (2) The applicant for a residents permit who surrenders a residents permit to the Council after the permit has become valid shall be entitled to a refund of the charge paid in respect of each full calendar month remaining unused before the end of the permit period calculated from the time of receipt by the Council of the surrendered permit.

## **PART 6**

### **RESIDENT'S VISITOR'S PERMITS**

30. (1) Any resident may apply to the Council for the issue of:-
- (a) one visitor's permit.
- (2) Any such application shall be made on a form issued by the Council and shall include the information required by such form and shall be accompanied by a remittance for such charge as is specified in Schedule 4.
- (3) On receipt of an application made under the foregoing provisions of this Article the Council, upon being satisfied that the applicant meets the requirements of this Article, shall issue to that applicant as appropriate:-
- (a) one visitor's permit, provided that, subject to the provisions of Article 32 or this Order, such a permit would not be valid for any period during which any other visitor's permit issued in respect of that residence would be valid.
- (4) The Council may at any time require an applicant for a visitor's permit to produce to an officer of the Council such evidence in respect of an application for a visitor's permit made to them as they may reasonably require to verify any information given to them.
31. (1) The holder of a visitor's permit may surrender the visitor's permit to the Council at any time and shall surrender a visitor's permit on the occurrence of any of the events in respect of a visitor's permit, as are set out in paragraph (3) of this Article.
- (2) The Council may, by notice in writing served on the holder of a visitor's permit by sending the same by recorded delivery service to the address shown by that person on the application for a visitor's permit or at any other address believed to be that person's residence, withdraw a visitor's permit if it appears to the Council that any one of the events in paragraph (3) of this Article has occurred and the holder shall surrender the visitor's permit to the Council within 48 hours of the service of such notice.
- (3) The events referred to in the foregoing provisions of this article are:
- (a) the holder of the visitor's permit ceasing to be a resident;
  - (b) the issue of a replacement visitor's permit under the provisions of Article 32 of this order;
  - (c) the visitor's permit having been obtained by fraudulent means.
- (4) A visitor's permit shall cease to be valid at the end of the visitor's permit specified

thereon or on the occurrence of any one of the events set out in paragraph (3) of this Article, whichever is the earlier.

- (5) The Council may at any time require the holder of a visitor's permit to produce to an officer of the Council such evidence in respect of any visitor's permit by them as they may reasonably require.
32. (1) If a visitor's permit is mutilated or defaced or the figures or particulars on it have become altered by fading or otherwise, the holder of the visitor's permit shall surrender to the Council and may apply to the Council for the issue to him of a replacement visitor's permit and the Council, upon the receipt of the permit if such receipt is accompanied by an application for a replacement visitor's permit and by a remittance for such charge as is specified in Schedule 4 shall issue a replacement visitor's permit so marked;
- (2) If a visitor's permit is lost or destroyed, the holder of the visitor's permit may apply to the Council for the issue to him of a replacement visitor's permit and the Council, upon being satisfied as to such loss or destruction, and upon receipt by the Council of an application for a replacement visitor's permit accompanied by a remittance for such charge as is specified in Schedule 4 shall issue a replacement visitor's permit so marked;
- (3) The provisions of this Order shall apply to a replacement visitor's permit and an application for a replacement visitor's permit as if it were a visitor's permit or, as the case may be, an application therefore.
33. A visitor's permit shall be in writing and shall include the following particulars:
- (1) the date of expiry being the last day of the permit period;
  - (2) an authentication that the permit has been issued by the Council.
34. A visitor's permit shall only be valid for the duration of the permit period.
35. (1) The applicant for a visitors permit who surrenders a visitors permit to the Council before the permit becomes valid shall be entitled to a refund of the charge paid in respect of the issue thereof;
- (2) The applicant for a visitors permit who surrenders a visitors permit to the Council after the permit has become valid shall be entitled to a refund of the charge paid in respect of each full calendar month remaining unused before the end of the permit period calculated from the time of receipt by the Council of the surrendered permit.

## **PART 7**

### **CARER'S PERMITS**

36. (1) Any public service body or an officially registered company employing carers who are required to make house calls as a part of their normal duty may apply to the Council for the issue of carer permits to be held or used by carers for the purpose of making visits to properties within the roads stated in Schedule 2B

- (2) Any such application shall be made on a form issued by the Council and shall include the information required by such form and shall be accompanied by a remittance for such charge as is specified in Schedule 4.
  - (3) Any person employed as a carer by a public service body or an officially registered company who is the user of passenger vehicle, dual purpose vehicle, goods vehicle, moped or motor cycle may validly obtain from the said public service body or officially registered company a carer permit for the leaving of the said vehicle in a parking place specified in Schedule 2A during the prescribed hours whilst making a house call as a part of their normal duty.
  - (4) On receipt of an application made under the foregoing provisions of this article by a public service body or officially registered company the Council upon being satisfied that the application meets the requirements of this article, shall issue to that applicant sufficient carer permits, provided that, subject to the provisions of Article 38 of this Order, any such permit would not be valid for any period during which any other carer permit issued to an individual vehicle would be valid.
  - (5) The Council may at any time require an applicant for a carer permit to produce to an officer of the Council such evidence in respect of an application for a carer permit made to them as they may reasonably require to verify any information given to them.
- 37.
- (1) The applicant for a carer permit, may surrender a carer permit to the Council at any time and shall surrender a carer permit to the Council on the occurrence of any of the events in respect of a carer permit, as are set out in paragraphs (3) or (5) of this article.
  - (2) The Council may, by notice in writing served on the applicant for a carer permit, by sending the same by the recorded delivery service to the address shown by that applicant on the application for the carer permits or at any other address believed to be that applicant's place of business or registered office, withdraw a carer permit if it appears to the Council that any one of the events in respect of a carer permit as set out in paragraph (3) of this article has occurred and the applicant for the carer permits shall surrender the carer permit to the Council within 48 hours of the service of such notice.
  - (3) The events referred to in the foregoing provisions of this article are:-
    - (a) the holder of a carer permit ceasing to be an eligible employee of a public service body or officially registered company by which they were employed at the time the application was made;
    - (b) the holder of a carer permit ceasing to be required to make house calls to properties defined in Schedule 2B as a part of their normal duty;
    - (c) the holder of a carer permit ceasing to be the user of the vehicle in respect of which the carers permit was issued;
    - (d) the vehicle in respect of which a carer permit was issued being adapted or used in such a manner that it is not a vehicle of the class specified in Article 36 of this Order;

- (e) the issue of a replacement carer permit by the Council under the provisions of Article 38 of this Order;
  - (f) the permit having been obtained by fraudulent means.
- (4) A carer permit shall cease to be valid at the end of the permit period specified thereon or on the occurrence of any one of the events set out in paragraph (3) of this article, whichever is the earlier;
- (5) Where a carer permit is issued to any applicant upon receipt of a cheque and the cheque is subsequently dishonoured, the permit shall cease to be valid and the Council shall by notice in writing served on the applicant to whom such a permit was issued by sending the same by the recorded delivery service to the applicant for the carer permit at the address shown by that applicant on the application for the permit or at any other address believed to be that applicant's place of business or registered office, require the surrender of the permit to the Council within 48 hours of the service of the aforementioned notice;
- (6) The Council may at any time require the applicant for, holder or user of a carer permit to produce to an officer of the Council such evidence in respect of any permit issued by them as they may reasonably require.
- 38.
  - (1) If a carer permit is mutilated or defaced or the figures or particulars on it have become illegible or the colour of the permit has become altered by fading or otherwise, the applicant for the carer permit shall surrender it to the Council and may apply to the Council for the issue to them of a replacement permit and the Council, upon the receipt of the carer permit if such receipt is accompanied by an application for a replacement carer permit and by a remittance for such charge as is specified in Schedule 4 shall issue a replacement permit so marked;
  - (2) If a carer permit is lost or destroyed, the applicant for the permit may apply to the Council for the issue to him of a replacement carer permit and the Council, upon being satisfied as to such loss or destruction, and upon receipt by the Council of an application for a replacement carer permit accompanied by a remittance for such charge as is specified in Schedule 4 shall issue a replacement permit so marked;
  - (3) The provisions of this Order shall apply to a replacement carer permit and an application for a replacement carer permit as if it were a carer permit or, as the case may be, an application therefor.
- 39. A carer permit shall be in writing and shall include the following particulars:-
  - (1) The registration mark of the vehicle in respect of which the permit has been issued;
  - (2) The month of expiry being the last day of the permit period;
  - (3) An authentication that the carer permit has been issued by the Council.
- 40. A carer permit shall only be valid for the duration of the permit period in respect of the year for which it is issued.
- 41.
  - (1) The applicant for a carer permit who surrenders a carer permit to the Council before the permit becomes valid shall be entitled to a refund of the

charge paid in respect of the issue thereof;

- (2) The applicant for a carer permit who surrenders a carers permit to the Council after the permit has become valid shall be entitled to a refund of the charge paid in respect of each full calendar month remaining unused before the end of the permit period calculated from the time of receipt by the Council of the surrendered permit.

## **PART 8**

### **BUSINESS PERMITS**

42. (1) Any business property or organisation located and named and/or numbered within the roads specified, in Schedule 3B to this Order may apply to the Council for the issue of a Business Permit for use by each of their employees who is the user of a passenger vehicle, a dual purpose vehicle or a goods vehicle other than a person to whom such vehicle has been let for hire or reward;
  - (2) Any person who is employed by a business or organisation located and named and/or numbered within the roads specified in Schedule 3B to this Order as an employee who is the user of a passenger vehicle, a dual purpose vehicle or a goods vehicle, may apply to the Council for the issue of an Business Permit for use by the user of such vehicle other than a person to whom such vehicle has been let for hire or reward;
  - (3) Any such application shall be made on a form issued by the Council and shall include the information required by such form and shall be accompanied by a remittance, if applicable, for such charge as is specified in Schedule 4.
  - (4) On receipt by the Council of an application made under the foregoing provisions of this Article the Council upon being satisfied that the applicant meets the requirements of this Article, shall issue to that applicant one Business Permit or, if the applicant is a business or organisation located and named and/or numbered within the roads specified in Schedule 3B to this Order sufficient Business Permits for each employee, provided that, subject to the provisions of Article 44 of this Order, such a Business Permit would not be valid for any period during which any other Business Permit issued to that person would be valid.
  - (5) The Council may at any time require an applicant for a Business Permit to produce to an officer of the Council such evidence in respect of an application for a Business Permit made to them as they may reasonably require to verify any information given to them.
43. (1) The holder of an Business Permit may surrender a Business Permit to the Council at any time and shall surrender a Business Permit to the Council on the occurrence of any of the events in respect of a Business Permit, as are set out in paragraphs (3) or (5) of this Article.
  - (2) The Council may, by notice in writing served on the holder of a Business Permit by sending the same by the recorded delivery service to the

address shown by that person on the application for the Business Permit or at any other address believed to be that person's residence, withdraw a Business Permit if it appears to the Council that any one of the events in respect of a Business Permit as set out in paragraph (3) of this Article has occurred and the holder of the Business Permit shall surrender the Business Permit to the Council within 48 hours of the service of such notice.

- (3) The events referred to in the foregoing provisions of this Article are:
- (a) the holder of a Business Permit ceasing to be an employee of a business or organisation which is located and named and/or numbered within the roads specified in Schedule 3B to this Order;
  - (b) the holder of a Business Permit ceasing to be the user of the vehicle in respect of which the Business Permit was issued;
  - (c) the vehicle in respect of which a Business Permit was issued being adapted or used in such a manner that it is not a vehicle of the class specified in Article 42 of this Order;
  - (d) the issue of a replacement Business Permit by the Council under the provisions of Article 44 of this Order;
  - (e) the Business Permit having been obtained by fraudulent means.
- (4) A Business Permit shall cease to be valid at the end of the permit period specified thereon or on the occurrence of any one of the events set out in paragraph (3) of this Article, whichever is the earlier;
- (5) Where a Business Permit is issued to any person upon receipt by the Council of a cheque and the cheque is subsequently dishonoured, the Business Permit shall cease to be valid and the Council shall by notice in writing served on the person to whom such a Business Permit was issued by sending the same by the recorded delivery service to the holder of the Business Permit at the address shown by that person on the application for the Business Permit or at any other address believed to be that person's place of residence, require that person to surrender the Business Permit to the Council within 48 hours of the service of the aforementioned notice;
- (6) The Council may at any time require the holder of a Business Permit to produce to an officer of the Council such evidence in respect of any Business Permit issued by them as they may reasonably require.

44. (1) If a Business Permit is mutilated or defaced or the figures or particulars on it have become illegible or the colour of the Business Permit has become altered by fading or otherwise, the holder of the Business Permit shall surrender it to the Council and may apply to the Council for the issue to him of a replacement Business Permit and the Council, upon the receipt of the Business Permit if such receipt is accompanied by an application for a replacement Business Permit and remittance, if applicable, for such charge as is specified in Schedule 4 shall issue a replacement Business

Permit so marked;

(2) If a Business Permit is lost or destroyed, the holder of the Business Permit may apply to the Council for the issue to him of a replacement Business Permit and the Council, upon being satisfied as to such loss or destruction, and upon receipt by the Council of an application for a replacement Business Permit, and a remittance, if applicable, for such charge as is specified in Schedule 4. shall issue a replacement Business Permit so marked;

(3) The provisions of this Order shall apply to a replacement Business Permit and an application for a replacement Business Permit as if it were an Business Permit or, as the case may be, an application therefor.

45. A Business Permit for an employee shall be in writing and shall include the following particulars:

(1) The registration mark of the vehicle in respect of which the Permit has been issued;

(2) The date of expiry being the last day of the permit period;

(3) An authentication that the Business Permit has been issued by the Council.

46. (1) The applicant for a business permit who surrenders a business permit to the Council before the permit becomes valid shall be entitled to a refund of the charge paid in respect of the issue thereof;

(2) The applicant for a business permit who surrenders a business permit to the Council after the permit has become valid shall be entitled to a refund of the charge paid in respect of each full calendar month remaining unused before the end of the permit period calculated from the time of receipt by the Council of the surrendered permit.

## **PART 9**

### **ENFORCEMENT OF RESTRICTIONS**

47. The Council shall, on or in the vicinity of a restricted road

(1) Highlight each restricted area with notices, signs and road surface markings in accordance with the Traffic Signs Regulations and General Directions Act 2002;

(2) Maintain and from time to time alter the said notices, signs and road-surface markings;

(3) Carry out such other work as is reasonably required for the purpose of the satisfactory operation of a restricted road.

48. The Council shall appoint Civil Enforcement Officers whose duty it shall be to patrol and enforce the waiting and parking restrictions imposed by the Articles of this Order.





**KEY:**

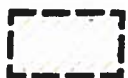

Free Parking Places

FP01-FP02  
FP08-FP09  
FP15-FP24

TRO Reference Numbers

Map referred to in the Council of the Borough of Milton Keynes (Conniburrow) (Off-Street Limited Waiting and Permit Parking Places) Order 2012

20727

Map 1

Not to Scale

The Common Seal of the Council of the Borough of Milton Keynes was hereunto affixed in the presence of:





**KEY:**

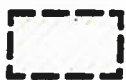

Free Parking Places

FP03-FP07  
FP10-FP14  
FP25-FP36

TRO Reference Numbers

Map referred to in the Council of the Borough of Milton Keynes (Conniburrow) (Off-Street Limited Waiting and Permit Parking Places) Order 2012

Map 2

Not to Scale

The Common Seal of the Council of the Borough of Milton Keynes was hereunto affixed in the presence of:

207 27



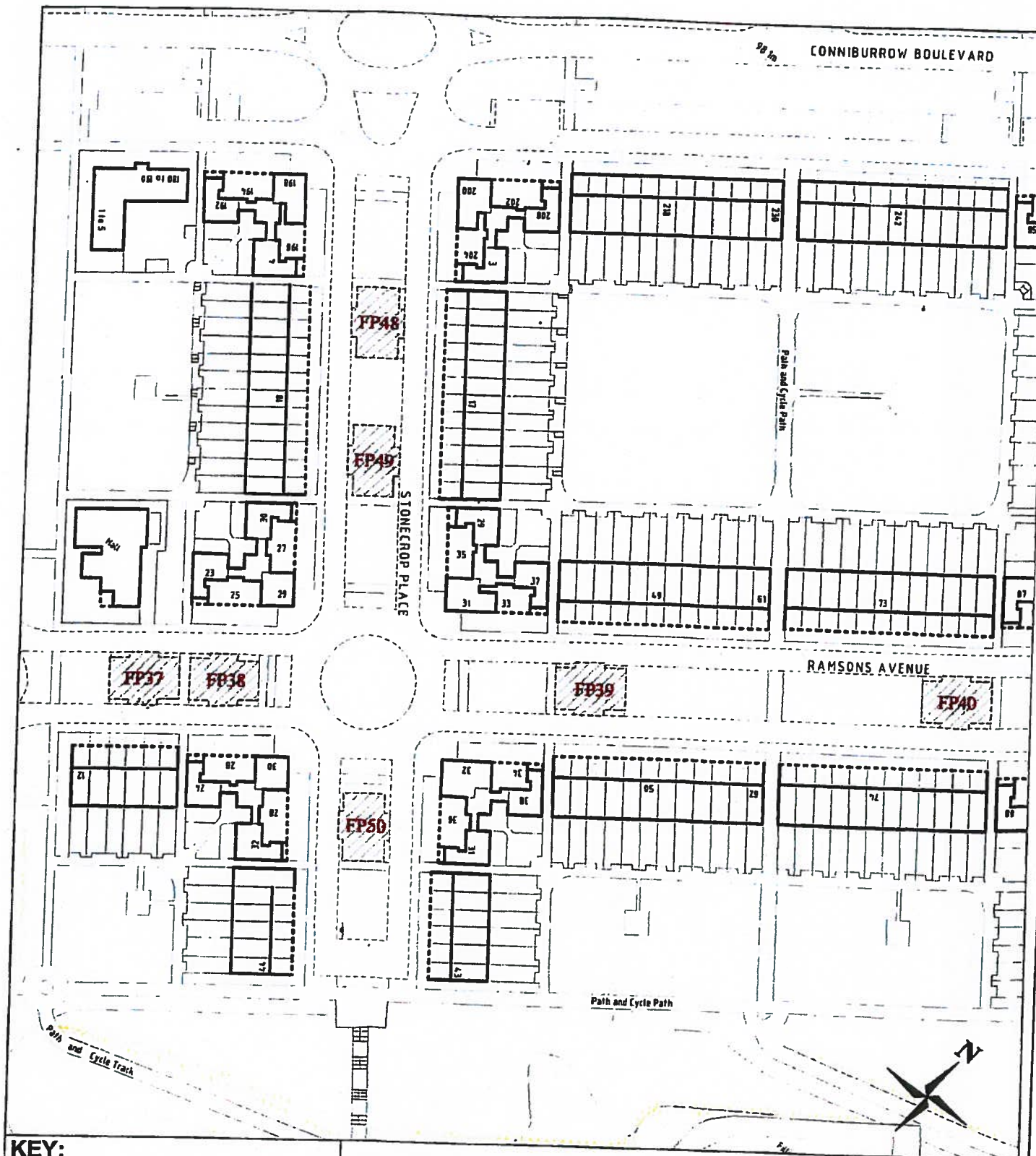

# **KEY:**

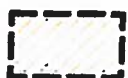

Free Parking Places

FP37-FP40  
FP48-FP50

TRO Reference Numbers

Map referred to in the Council of the Borough of Milton Keynes (Conniburrow) (Off-Street Limited Waiting and Permit Parking Places) Order 2012

Map 3

Not to Scale

The Common Seal of the Council of the Borough of Milton Keynes was hereunto affixed in the presence of:

*[Handwritten signature]*

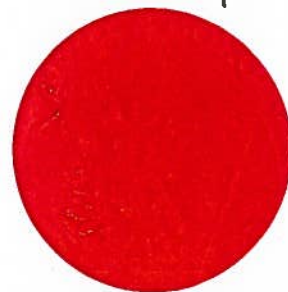

20727



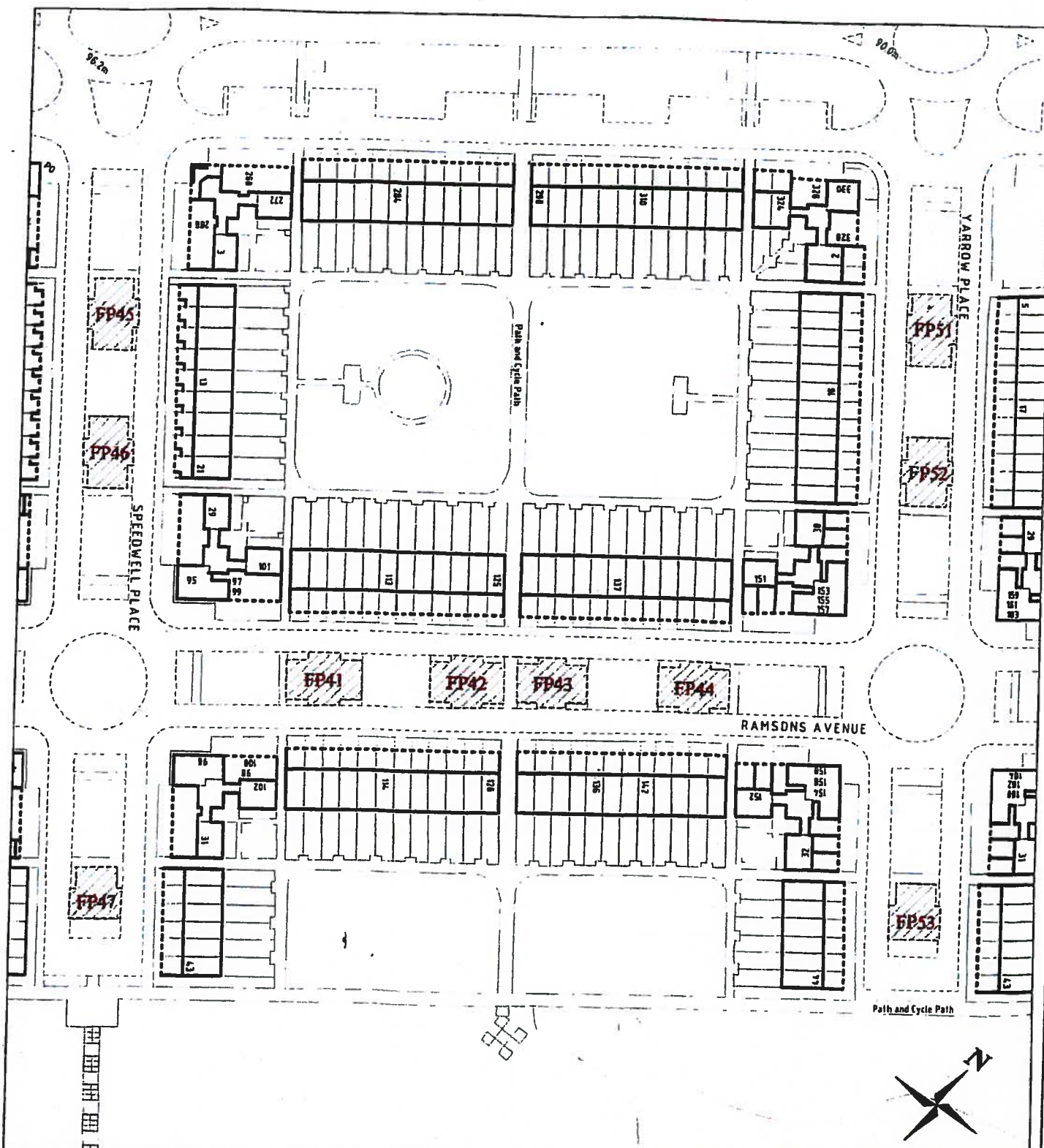

**KEY:**



Free Parking  
Places

FP41-FP47  
FP51-FP53

TRO Reference  
Numbers

Map referred to in the Council of the Borough of  
Milton Keynes (Conniburrow) (Off-Street Limited Waiting  
and Permit Parking Places)  
Order 2012

Map 4

Not to Scale

The Common Seal of the Council of the Borough  
of Milton Keynes was hereunto affixed in the  
presence of:

20727



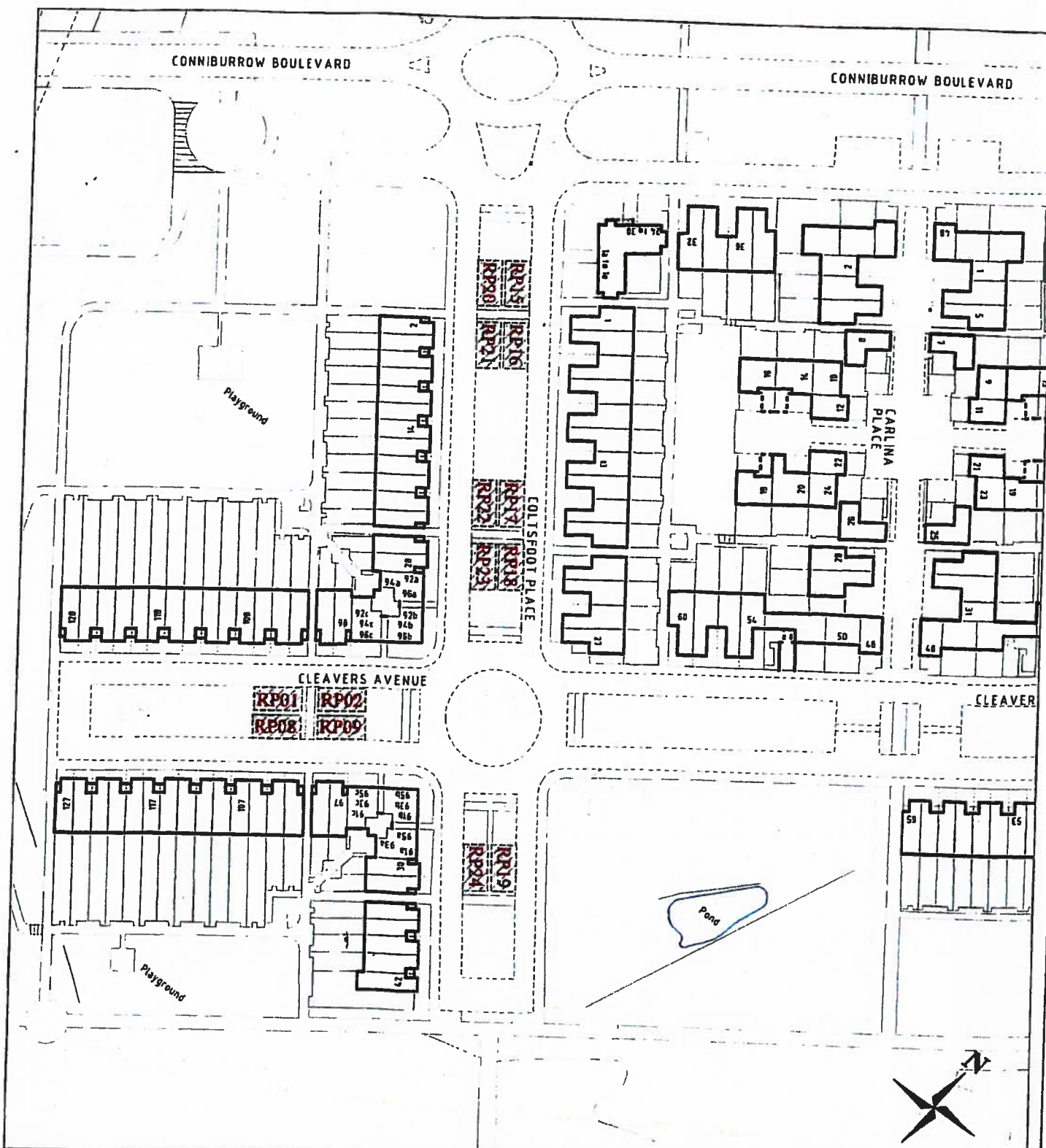

**KEY:**

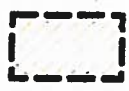
 Residents Permit Parking Places

RP01-RP02  
RP08-RP09  
RP15-RP24

TRO Reference Numbers

Map referred to in the Council of the Borough of Milton Keynes (Conniburrow) (Off-Street Limited Waiting and Permit Parking Places) Order 2012

Map 5

Not to Scale

The Common Seal of the Council of the Borough of Milton Keynes was hereunto affixed in the presence of:

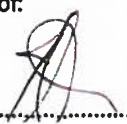

20727



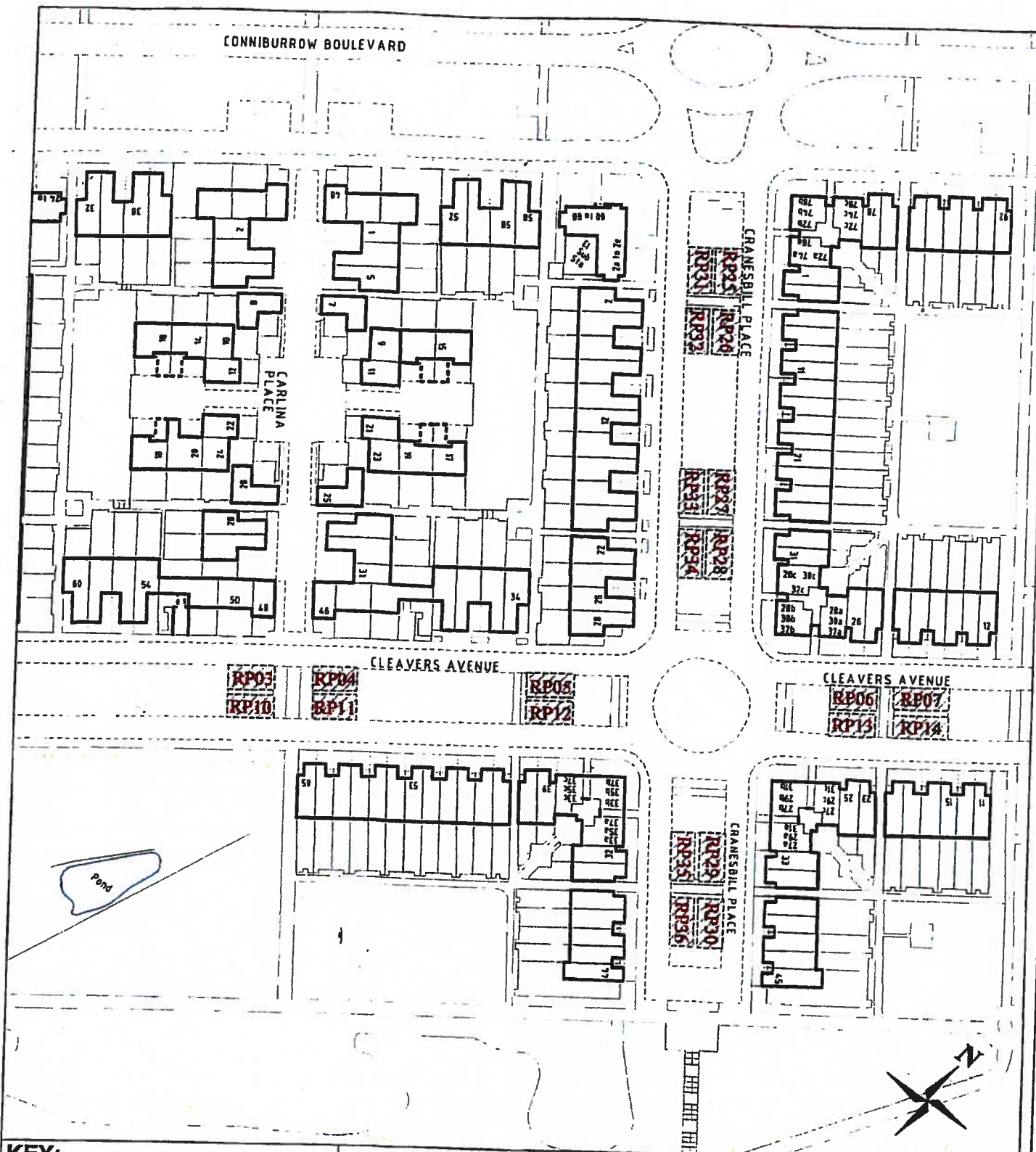

**KEY:**

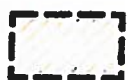

Residents Permit  
Parking Places

RP03-RP07  
RP10-RP14  
RP25-RP36

TRO Reference  
Numbers

Map referred to in the Council of the Borough of  
Milton Keynes (Conniburrow) (Off-Street Limited Waiting  
and Permit Parking Places)  
Order 2012

Map 6

Not to Scale

The Common Seal of the Council of the Borough  
of Milton Keynes was hereunto affixed in the  
presence of:

20727





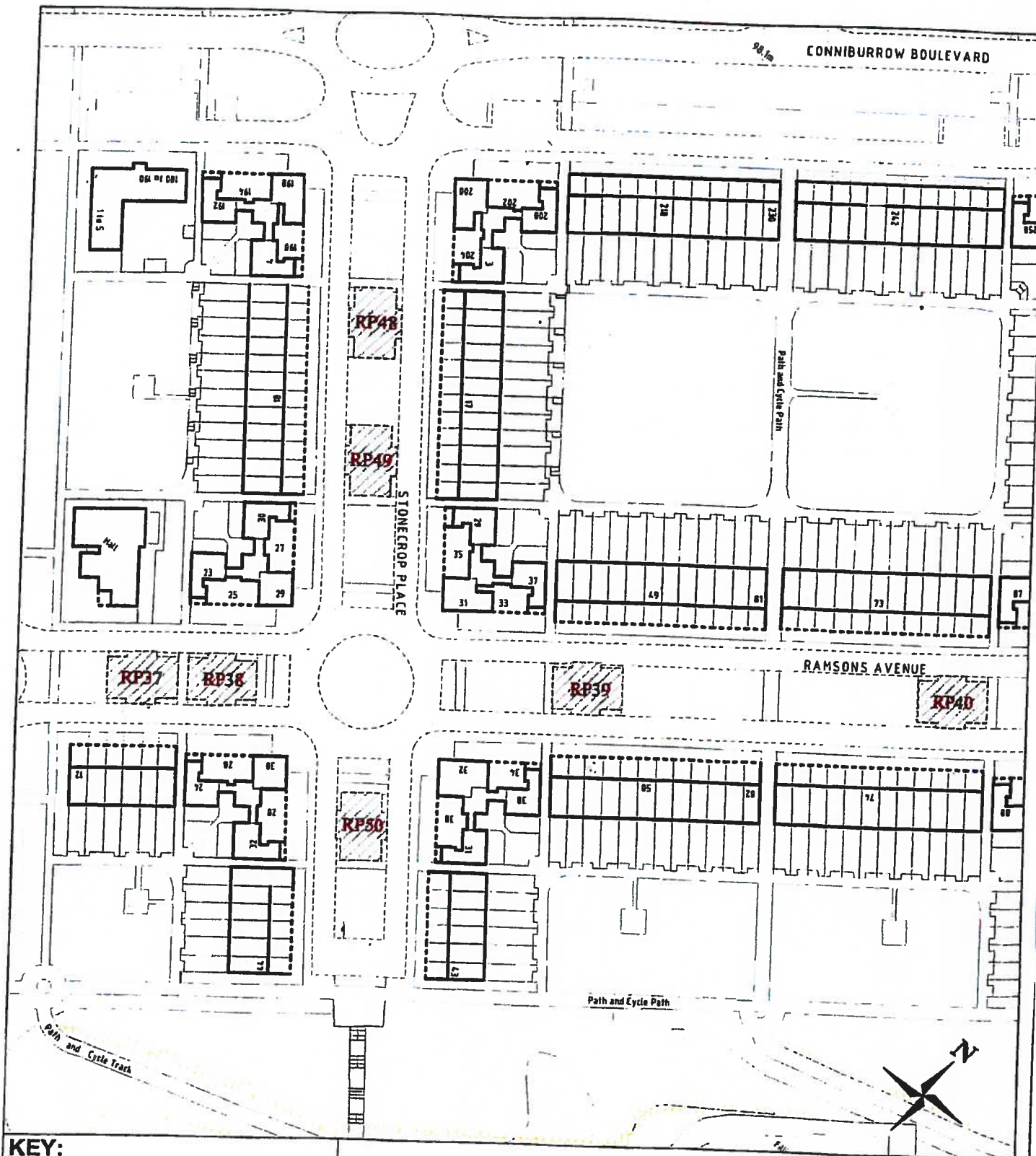

**KEY:**

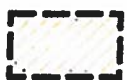

Residents Permit  
Parking Places

RP37-RP40  
RP48-RP50

TRO Reference  
Numbers

Map referred to in the Council of the Borough of  
Milton Keynes (Conniburrow) (Off-Street Limited Waiting  
and Permit Parking Places)  
Order 2012

Map 7

Not to Scale

The Common Seal of the Council of the Borough  
of Milton Keynes was hereunto affixed in the  
presence of:

20727



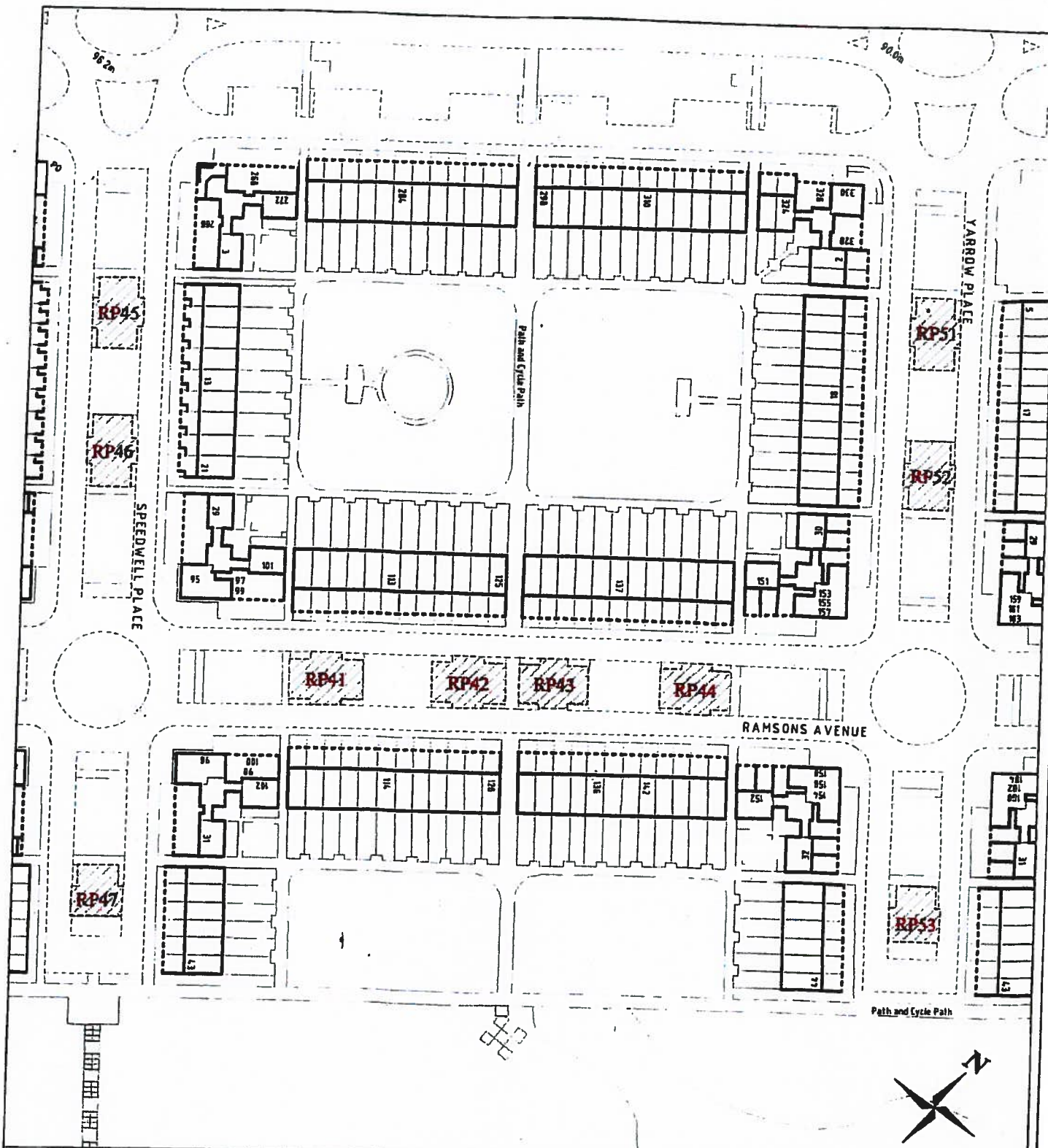

**KEY:**

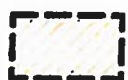

**Residents Permit  
Parking Places**

**RP41-RP47  
RP51-RP53**

**TRO Reference  
Numbers**

Map referred to in the Council of the Borough of  
Milton Keynes (Conniburrow) (Off-Street Limited Waiting  
and Permit Parking Places)  
Order 2012

20727

Map 8

Not to Scale

The Common Seal of the Council of the Borough  
of Milton Keynes was hereunto affixed in the  
presence of:

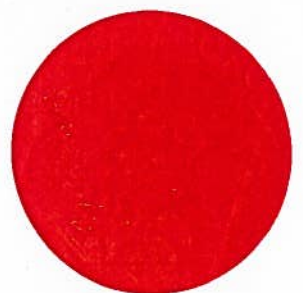



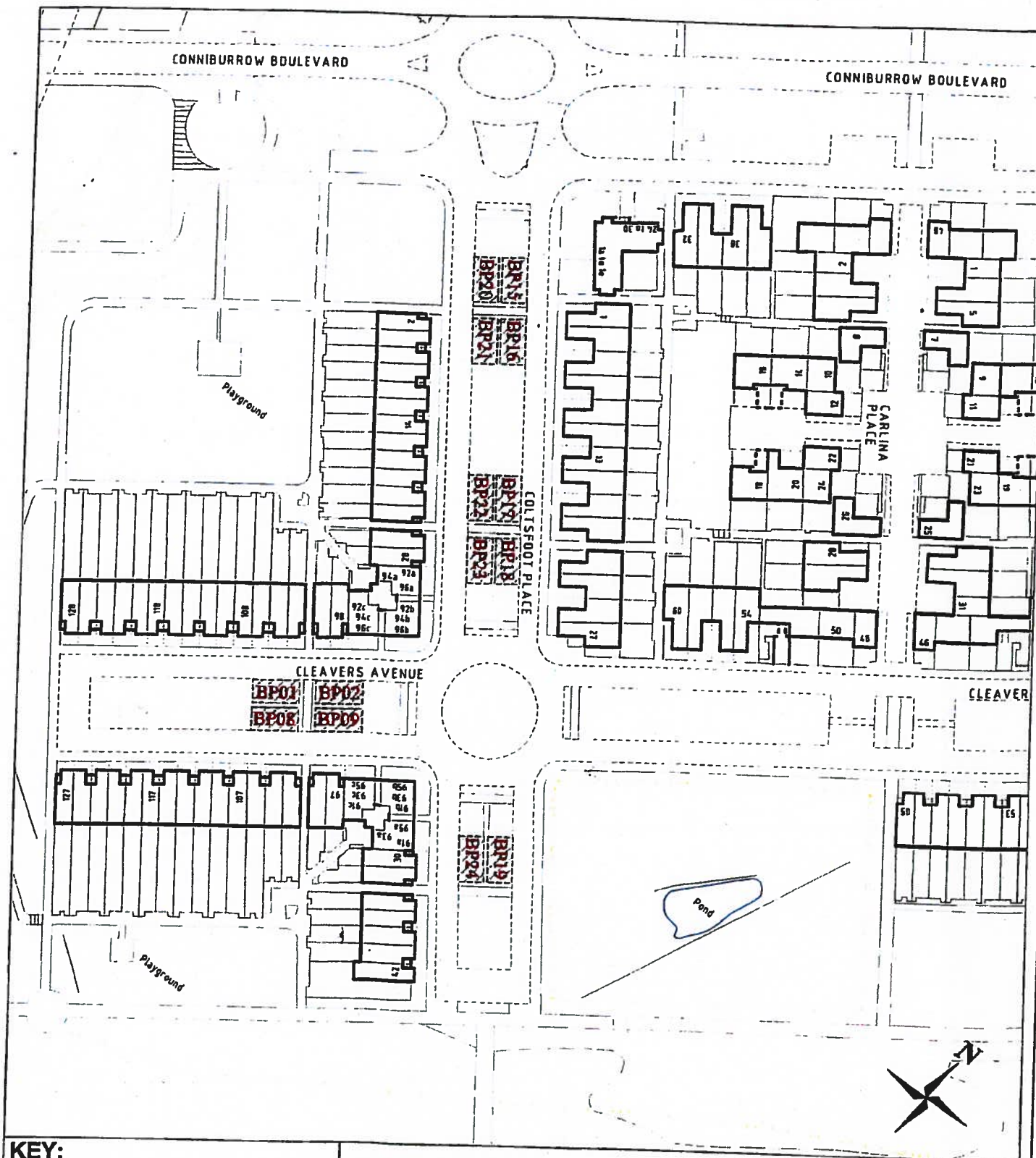

**KEY:**

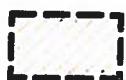

Business Permit  
Parking Places

BP01-BP02  
BP08-BP09  
BP15-BP24

TRO Reference  
Numbers

Map referred to in the Council of the Borough of  
Milton Keynes (Conniburrow) (Off-Street Limited Waiting  
and Permit Parking Places)  
Order 2012

20727

Map 9

Not to Scale

The Common Seal of the Council of the Borough  
of Milton Keynes was hereunto affixed in the  
presence of:





**KEY:**



Business Permit  
Parking Places

BP03-BP07  
BP10-BP14  
BP25-BP36

TRO Reference  
Numbers

Map referred to in the Council of the Borough of  
Milton Keynes (Conniburrow) (Off-Street Limited Waiting  
and Permit Parking Places)  
Order 2012

Map 10

Not to Scale

The Common Seal of the Council of the Borough  
of Milton Keynes was hereunto affixed in the  
presence of:

*[Signature]*

20727



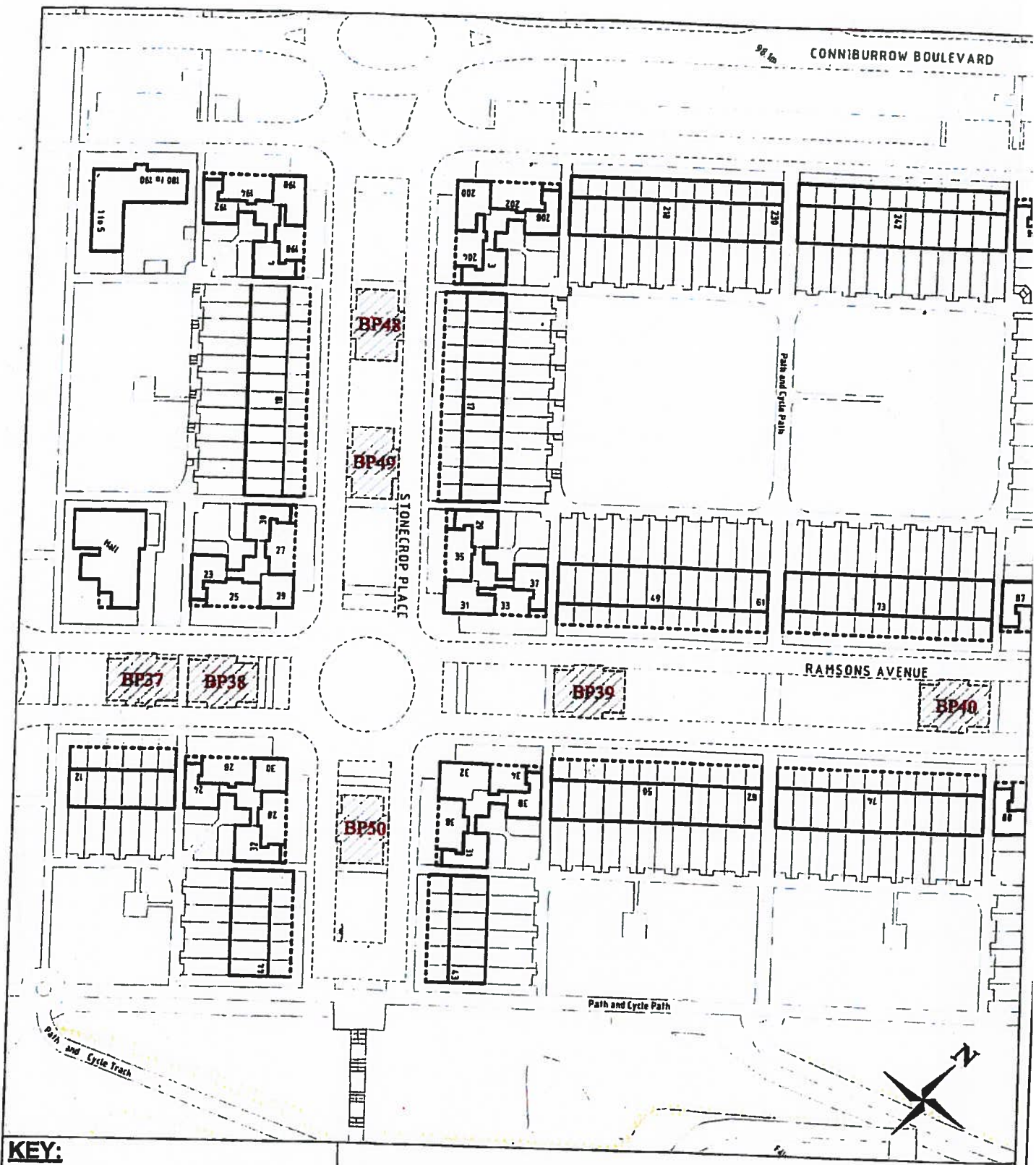

**KEY:**



**Business Permit  
Parking Places**

**BP37-BP40  
BP48-BP50**

**TRO Reference  
Numbers**

Map referred to in the Council of the Borough of  
Milton Keynes (Conniburrow) (Off-Street Limited Waiting  
and Permit Parking Places)  
Order 2012

20727

Map 11

Not to Scale

The Common Seal of the Council of the Borough  
of Milton Keynes was hereunto affixed in the  
presence of:





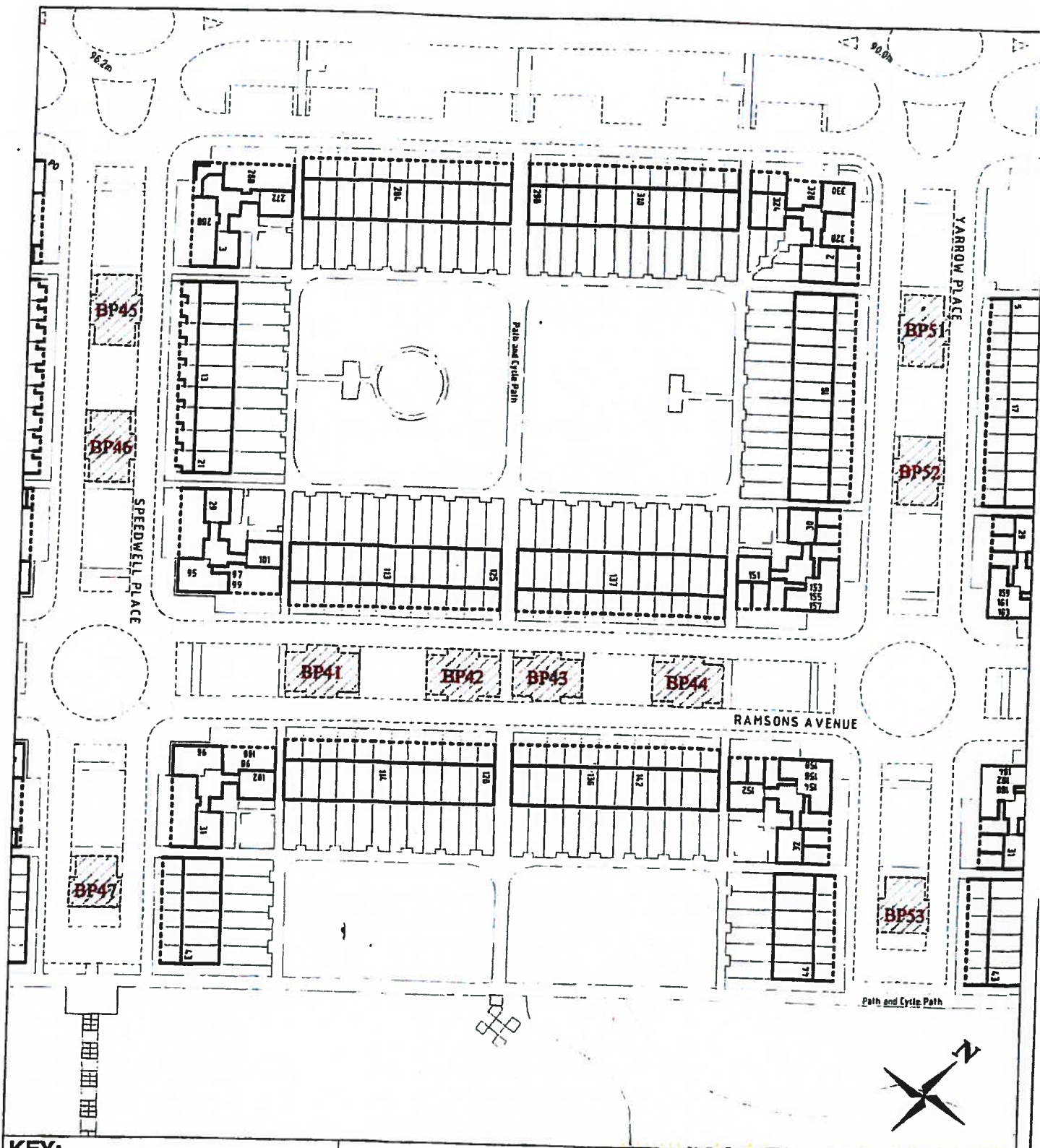

**KEY:**

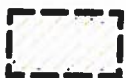

Business Permit  
Parking Places

BP41-BP47  
BP51-BP53

TRO Reference  
Numbers

Map referred to in the Council of the Borough of  
Milton Keynes (Conniburrow) (Off-Street Limited Waiting  
and Permit Parking Places)  
Order 2012

Map 12

Not to Scale

The Common Seal of the Council of the Borough  
of Milton Keynes was hereunto affixed in the  
presence of:

20727

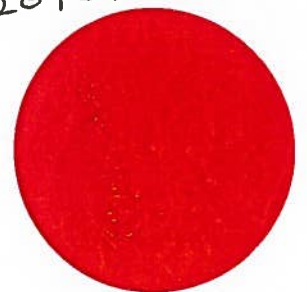

## **SCHEDULE 1**

### **OFF-STREET FREE AND LIMITED PARKING PLACES**

#### **EXCEPT WITHIN THE MARKED BICYCLE/MOTOR CYCLE AND DISABLED PERSONS' PARKING BAYS**

#### **BETWEEN THE HOURS OF 9.00 AM TO 11.00 AM AND 2.00 PM TO 4.00 PM MONDAY TO SATURDAY**

#### **FOR A MAXIMUM PERIOD OF 30 MINUTES – RETURN PROHIBITED WITHIN 1 HOUR**

##### **CLEAVERS AVENUE, CONNIBURROW**

##### **CENTRAL RESERVATION, NORTH-WEST SIDE**

- FP01 From a point approximately 25.5 metres south-west of its junction with Coltsfoot Place, continuing for a distance of approximately 9.5 metres in a south-westerly direction
- FP02 From a point approximately 11.5 metres south-west of its junction with Coltsfoot Place, continuing for a distance of approximately 9.5 metres in a south-westerly direction
- FP03 From a point approximately 60 metres north-east of its junction with Coltsfoot Place, continuing for a distance of approximately 9.5 metres in a north-easterly direction
- FP04 From a point approximately 77.5 metres north-east of its junction with Coltsfoot Place, continuing for a distance of approximately 9.5 metres in a north-easterly direction
- FP05 From a point approximately 12 metres south-west of its junction with Cranesbill Place, continuing for a distance of approximately 9 metres in a south-westerly direction
- FP06 From a point approximately 12 metres north-east of its junction with Cranesbill Place, continuing for a distance of approximately 9.5 metres in a north-easterly direction
- FP07 From a point approximately 26 metres north-east of its junction with Cranesbill Place, continuing for a distance of approximately 9.5 metres in a north-easterly direction

##### **CENTRAL RESERVATION, SOUTH-EAST SIDE**

- FP08 From a point approximately 25.5 metres south-west of its junction with Coltsfoot Place, continuing for a distance of approximately 9.5 metres in a south-westerly direction
- FP09 From a point approximately 11.5 metres south-west of its junction with Coltsfoot Place, continuing for a distance of approximately 9.5 metres in a south-westerly direction
- FP10 From a point approximately 60 metres north-east of its junction with Coltsfoot Place, continuing for a distance of approximately 9.5 metres in a north-easterly direction
- FP11 From a point approximately 77.5 metres north-east of its junction with Coltsfoot Place, continuing for a distance of approximately 9.5 metres in a north-easterly direction
- FP12 From a point approximately 12 metres south-west of its junction with Cranesbill Place, continuing for a distance of approximately 9 metres in a south-westerly direction
- FP13 From a point approximately 12 metres north-east of its junction with Cranesbill Place, continuing for a distance of approximately 9.5 metres in a north-easterly direction

- FP14 From a point approximately 26 metres north-east of its junction with Cranesbill Place, continuing for a distance of approximately 9.5 metres in a north-easterly direction

COLTSFOOT PLACE, CONNIBURROW  
CENTRAL RESERVATION, NORTH-EAST SIDE

- FP15 From a point approximately 12.5 metres south-east of its junction with Conniburrow Boulevard, continuing for a distance of approximately 9.5 metres in a south-easterly direction
- FP16 From a point approximately 27 metres south-east of its junction with Conniburrow Boulevard, continuing for a distance of approximately 9.5 metres in a south-easterly direction
- FP17 From a point approximately 25.5 metres north-west of its junction with Cleavers Avenue, continuing for a distance of approximately 9.5 metres in a north-westerly direction
- FP18 From a point approximately 11.5 metres north-west of its junction with Cleavers Avenue, continuing for a distance of approximately 9.5 metres in a north-westerly direction
- FP19 From a point approximately 12.5 metres south-east of its junction with Cleavers Avenue, continuing for a distance of approximately 9.5 metres in a south-easterly direction

CENTRAL RESERVATION, SOUTH-WEST SIDE

- FP20 From a point approximately 12.5 metres south-east of its junction with Conniburrow Boulevard, continuing for a distance of approximately 9.5 metres in a south-easterly direction
- FP21 From a point approximately 27 metres south-east of its junction with Conniburrow Boulevard, continuing for a distance of approximately 9.5 metres in a south-easterly direction
- FP22 From a point approximately 25.5 metres north-west of its junction with Cleavers Avenue, continuing for a distance of approximately 9.5 metres in a north-westerly direction
- FP23 From a point approximately 11.5 metres north-west of its junction with Cleavers Avenue, continuing for a distance of approximately 9.5 metres in a north-westerly direction
- FP24 From a point approximately 12.5 metres south-east of its junction with Cleavers Avenue, continuing for a distance of approximately 9.5 metres in a south-easterly direction

CRANESBILL PLACE, CONNIBURROW  
CENTRAL RESERVATION, NORTH-EAST SIDE

- FP25 From a point approximately 12.5 metres south-east of its junction with Conniburrow Boulevard, continuing for a distance of approximately 9.5 metres in a south-easterly direction
- FP26 From a point approximately 26.5 metres south-east of its junction with Conniburrow Boulevard, continuing for a distance of approximately 9.5 metres in a south-easterly direction
- FP27 From a point approximately 26 metres north-west of its junction with Cleavers Avenue, continuing for a distance of approximately 9.5 metres in a north-westerly direction

- FP28 From a point approximately 12 metres north-west of its junction with Cleavers Avenue, continuing for a distance of approximately 9.5 metres in a north-westerly direction
- FP29 From a point approximately 12 metres south-east of its junction with Cleavers Avenue, continuing for a distance of approximately 9.5 metres in a south-easterly direction
- FP30 From a point approximately 25.5 metres south-east of its junction with Cleavers Avenue, continuing for a distance of approximately 9.5 metres in a south-easterly direction

#### CENTRAL RESERVATION, SOUTH-WEST SIDE

- FP31 From a point approximately 12.5 metres south-east of its junction with Conniburrow Boulevard, continuing for a distance of approximately 9.5 metres in a south-easterly direction
- FP32 From a point approximately 26.5 metres south-east of its junction with Conniburrow Boulevard, continuing for a distance of approximately 9.5 metres in a south-easterly direction
- FP33 From a point approximately 26 metres north-west of its junction with Cleavers Avenue, continuing for a distance of approximately 9.5 metres in a north-westerly direction
- FP34 From a point approximately 12 metres north-west of its junction with Cleavers Avenue, continuing for a distance of approximately 9.5 metres in a north-westerly direction
- FP35 From a point approximately 12 metres south-east of its junction with Cleavers Avenue, continuing for a distance of approximately 9.5 metres in a south-easterly direction
- FP36 From a point approximately 25.5 metres south-east of its junction with Cleavers Avenue, continuing for a distance of approximately 9.5 metres in a south-easterly direction

#### RAMSONS AVENUE, CONNIBURROW CENTRAL RESERVATION

- FP37 From a point approximately 18.5 metres north-east of its junction with Mallow Gate, continuing for a distance of approximately 15.5 metres in a north-easterly direction
- FP38 From a point approximately 7.5 metres south-west of its junction with Stonecrop Place, continuing for a distance of approximately 15.5 metres in a south-westerly direction
- FP39 From a point approximately 25 metres north-east of its junction with Stonecrop Place, continuing for a distance of approximately 15.5 metres in a north-easterly direction
- FP40 From a point approximately 25 metres south-west of its junction with Speedwell Place, continuing for a distance of approximately 15.5 metres in a south-westerly direction
- FP41 From a point approximately 25 metres north-east of its junction with Speedwell Place, continuing for a distance of approximately 15.5 metres in a north-easterly direction
- FP42 From a point approximately 56 metres north-east of its junction with Speedwell Place, continuing for a distance of approximately 15.5 metres in a north-easterly direction
- FP43 From a point approximately 55.5 metres south-west of its junction with Yarrow Place, continuing for a distance of approximately 16 metres in a south-westerly direction

- FP44 From a point approximately 24.5 metres south-west of its junction with Yarrow Place, continuing for a distance of approximately 16 metres in a south-westerly direction

**SPEEDWELL PLACE, CONNIBURROW  
CENTRAL RESERVATION**

- FP45 From a point approximately 25 metres south-east of its junction with Conniburrow Boulevard, continuing for a distance of approximately 15.5 metres in a south-easterly direction
- FP46 From a point approximately 24.5 metres north-west of its junction with Cleavers Avenue, continuing for a distance of approximately 15.5 metres in a north-westerly direction
- FP47 From a point approximately 24.5 metres south-east of its junction with Cleavers Avenue, continuing for a distance of approximately 11.5 metres in a south-easterly direction

**STONECROP PLACE, CONNIBURROW  
CENTRAL RESERVATION**

- FP48 From a point approximately 25 metres south-east of its junction with Conniburrow Boulevard, continuing for a distance of approximately 16 metres in a south-easterly direction
- FP49 From a point approximately 24.5 metres north-west of its junction with Cleavers Avenue, continuing for a distance of approximately 16 metres in a north-westerly direction
- FP50 From a point approximately 7.5 metres south-east of its junction with Cleavers Avenue, continuing for a distance of approximately 16 metres in a south-easterly direction

**YARROW PLACE, CONNIBURROW  
CENTRAL RESERVATION**

- FP51 From a point approximately 25 metres south-east of its junction with Conniburrow Boulevard, continuing for a distance of approximately 15.5 metres in a south-easterly direction
- FP52 From a point approximately 25 metres north-west of its junction with Cleavers Avenue, continuing for a distance of approximately 15.5 metres in a north-westerly direction
- FP53 From a point approximately 24.5 metres south-east of its junction with Cleavers Avenue, continuing for a distance of approximately 11.5 metres in a south-easterly direction

**SCHEDULE 2A**

**RESIDENTS' PERMIT PARKING PLACES**

**PARKING PLACES FOR USE BY VEHICLES DISPLAYING A RESIDENT'S PERMIT,  
RESIDENT'S VISITORS' PERMIT OR CARER'S PERMIT**

**EXCEPT WITHIN THE MARKED BICYCLE/MOTOR CYCLE  
AND DISABLED PERSONS' PARKING BAYS**

CLEAVERS AVENUE, CONNIBURROW  
CENTRAL RESERVATION, NORTH-WEST SIDE



- RP01 From a point approximately 25.5 metres south-west of its junction with Coltsfoot Place, continuing for a distance of approximately 9.5 metres in a south-westerly direction
- RP02 From a point approximately 11.5 metres south-west of its junction with Coltsfoot Place, continuing for a distance of approximately 9.5 metres in a south-westerly direction
- RP03 From a point approximately 60 metres north-east of its junction with Coltsfoot Place, continuing for a distance of approximately 9.5 metres in a north-easterly direction
- RP04 From a point approximately 77.5 metres north-east of its junction with Coltsfoot Place, continuing for a distance of approximately 9.5 metres in a north-easterly direction
- RP05 From a point approximately 12 metres south-west of its junction with Cranesbill Place, continuing for a distance of approximately 9 metres in a south-westerly direction
- RP06 From a point approximately 12 metres north-east of its junction with Cranesbill Place, continuing for a distance of approximately 9.5 metres in a north-easterly direction
- RP07 From a point approximately 26 metres north-east of its junction with Cranesbill Place, continuing for a distance of approximately 9.5 metres in a north-easterly direction

#### CENTRAL RESERVATION, SOUTH-EAST SIDE

- RP08 From a point approximately 25.5 metres south-west of its junction with Coltsfoot Place, continuing for a distance of approximately 9.5 metres in a south-westerly direction
- RP09 From a point approximately 11.5 metres south-west of its junction with Coltsfoot Place, continuing for a distance of approximately 9.5 metres in a south-westerly direction
- RP10 From a point approximately 60 metres north-east of its junction with Coltsfoot Place, continuing for a distance of approximately 9.5 metres in a north-easterly direction
- RP11 From a point approximately 77.5 metres north-east of its junction with Coltsfoot Place, continuing for a distance of approximately 9.5 metres in a north-easterly direction
- RP12 From a point approximately 12 metres south-west of its junction with Cranesbill Place, continuing for a distance of approximately 9 metres in a south-westerly direction
- RP13 From a point approximately 12 metres north-east of its junction with Cranesbill Place, continuing for a distance of approximately 9.5 metres in a north-easterly direction
- RP14 From a point approximately 26 metres north-east of its junction with Cranesbill Place, continuing for a distance of approximately 9.5 metres in a north-easterly direction

#### COLTSFOOT PLACE, CONNIBURROW

##### CENTRAL RESERVATION, NORTH-EAST SIDE

- RP15 From a point approximately 12.5 metres south-east of its junction with Conniburrow Boulevard, continuing for a distance of approximately 9.5 metres in a south-easterly direction
- RP16 From a point approximately 27 metres south-east of its junction with Conniburrow Boulevard, continuing for a distance of approximately 9.5 metres in a south-easterly direction
- RP17 From a point approximately 25.5 metres north-west of its junction with Cleavers Avenue, continuing for a distance of approximately 9.5 metres in a north-westerly direction

- RP18 From a point approximately 11.5 metres north-west of its junction with Cleavers Avenue, continuing for a distance of approximately 9.5 metres in a north-westerly direction
- RP19 From a point approximately 12.5 metres south-east of its junction with Cleavers Avenue, continuing for a distance of approximately 9.5 metres in a south-easterly direction

#### CENTRAL RESERVATION, SOUTH-WEST SIDE

- RP20 From a point approximately 12.5 metres south-east of its junction with Conniburrow Boulevard, continuing for a distance of approximately 9.5 metres in a south-easterly direction
- RP21 From a point approximately 27 metres south-east of its junction with Conniburrow Boulevard, continuing for a distance of approximately 9.5 metres in a south-easterly direction
- RP22 From a point approximately 25.5 metres north-west of its junction with Cleavers Avenue, continuing for a distance of approximately 9.5 metres in a north-westerly direction
- RP23 From a point approximately 11.5 metres north-west of its junction with Cleavers Avenue, continuing for a distance of approximately 9.5 metres in a north-westerly direction
- RP24 From a point approximately 12.5 metres south-east of its junction with Cleavers Avenue, continuing for a distance of approximately 9.5 metres in a south-easterly direction

#### CRANESBILL PLACE, CONNIBURROW

##### CENTRAL RESERVATION, NORTH-EAST SIDE

- RP25 From a point approximately 12.5 metres south-east of its junction with Conniburrow Boulevard, continuing for a distance of approximately 9.5 metres in a south-easterly direction
- RP26 From a point approximately 26.5 metres south-east of its junction with Conniburrow Boulevard, continuing for a distance of approximately 9.5 metres in a south-easterly direction
- RP27 From a point approximately 26 metres north-west of its junction with Cleavers Avenue, continuing for a distance of approximately 9.5 metres in a north-westerly direction
- RP28 From a point approximately 12 metres north-west of its junction with Cleavers Avenue, continuing for a distance of approximately 9.5 metres in a north-westerly direction
- RP29 From a point approximately 12 metres south-east of its junction with Cleavers Avenue, continuing for a distance of approximately 9.5 metres in a south-easterly direction
- RP30 From a point approximately 25.5 metres south-east of its junction with Cleavers Avenue, continuing for a distance of approximately 9.5 metres in a south-easterly direction

##### CENTRAL RESERVATION, SOUTH-WEST SIDE

- RP31 From a point approximately 12.5 metres south-east of its junction with Conniburrow Boulevard, continuing for a distance of approximately 9.5 metres in a south-easterly direction
- RP32 From a point approximately 26.5 metres south-east of its junction with Conniburrow Boulevard, continuing for a distance of approximately 9.5 metres in a south-easterly direction

- RP33 From a point approximately 26 metres north-west of its junction with Cleavers Avenue, continuing for a distance of approximately 9.5 metres in a north-westerly direction
- RP34 From a point approximately 12 metres north-west of its junction with Cleavers Avenue, continuing for a distance of approximately 9.5 metres in a north-westerly direction
- RP35 From a point approximately 12 metres south-east of its junction with Cleavers Avenue, continuing for a distance of approximately 9.5 metres in a south-easterly direction
- RP36 From a point approximately 25.5 metres south-east of its junction with Cleavers Avenue, continuing for a distance of approximately 9.5 metres in a south-easterly direction

#### RAMSONS AVENUE, CONNIBURROW CENTRAL RESERVATION

- RP37 From a point approximately 18.5 metres north-east of its junction with Mallow Gate, continuing for a distance of approximately 15.5 metres in a north-easterly direction
- RP38 From a point approximately 7.5 metres south-west of its junction with Stonecrop Place, continuing for a distance of approximately 15.5 metres in a south-westerly direction
- RP39 From a point approximately 25 metres north-east of its junction with Stonecrop Place, continuing for a distance of approximately 15.5 metres in a north-easterly direction
- RP40 From a point approximately 25 metres south-west of its junction with Speedwell Place, continuing for a distance of approximately 15.5 metres in a south-westerly direction
- RP41 From a point approximately 25 metres north-east of its junction with Speedwell Place, continuing for a distance of approximately 15.5 metres in a north-easterly direction
- RP42 From a point approximately 56 metres north-east of its junction with Speedwell Place, continuing for a distance of approximately 15.5 metres in a north-easterly direction
- RP43 From a point approximately 55.5 metres south-west of its junction with Yarrow Place, continuing for a distance of approximately 16 metres in a south-westerly direction
- RP44 From a point approximately 24.5 metres south-west of its junction with Yarrow Place, continuing for a distance of approximately 16 metres in a south-westerly direction

#### SPEEDWELL PLACE, CONNIBURROW CENTRAL RESERVATION

- RP45 From a point approximately 25 metres south-east of its junction with Conniburrow Boulevard, continuing for a distance of approximately 15.5 metres in a south-easterly direction
- RP46 From a point approximately 24.5 metres north-west of its junction with Cleavers Avenue, continuing for a distance of approximately 15.5 metres in a north-westerly direction
- RP47 From a point approximately 24.5 metres south-east of its junction with Cleavers Avenue, continuing for a distance of approximately 11.5 metres in a south-easterly direction

**STONECROP PLACE, CONNIBURROW  
CENTRAL RESERVATION**

- RP48 From a point approximately 25 metres south-east of its junction with Conniburrow Boulevard, continuing for a distance of approximately 16 metres in a south-easterly direction
- RP49 From a point approximately 24.5 metres north-west of its junction with Cleavers Avenue, continuing for a distance of approximately 16 metres in a north-westerly direction
- RP50 From a point approximately 7.5 metres south-east of its junction with Cleavers Avenue, continuing for a distance of approximately 16 metres in a south-easterly direction

**YARROW PLACE, CONNIBURROW  
CENTRAL RESERVATION**

- RP51 From a point approximately 25 metres south-east of its junction with Conniburrow Boulevard, continuing for a distance of approximately 15.5 metres in a south-easterly direction
- RP52 From a point approximately 25 metres north-west of its junction with Cleavers Avenue, continuing for a distance of approximately 15.5 metres in a north-westerly direction
- RP53 From a point approximately 24.5 metres south-east of its junction with Cleavers Avenue, continuing for a distance of approximately 11.5 metres in a south-easterly direction

**SCHEDULE 2B**

**RESIDENTIAL PROPERTIES THAT ARE ELIGIBLE TO APPLY FOR RESIDENT'S PERMITS,  
RESIDENT'S VISITOR'S PERMITS AND CARER'S PERMITS**

**CONNIBURROW**

1. Carlina Place – All properties
2. Cleavers Avenue – All properties
3. Coltsfoot Place – All properties
4. Conniburrow Boulevard – Numbers 24 – 330 (even numbers)
5. Cranesbill Place – All properties
6. Mallow Gate – All properties
7. Ramsons Avenue – All properties
8. Speedwell Place – All properties
9. Stonecrop Place – All properties
10. Yarrow Place – All properties

## **SCHEDULE 3A**

### **BUSINESS PERMIT PARKING PLACES**

#### **PARKING PLACES FOR USE BY VEHICLES DISPLAYING A BUSINESS PERMIT**

##### **EXCEPT WITHIN THE MARKED BICYCLE/MOTOR CYCLE AND DISABLED PERSONS' PARKING BAYS**

###### **CLEAVERS AVENUE, CONNIBURROW**

###### **CENTRAL RESERVATION, NORTH-WEST SIDE**

- BP01 From a point approximately 25.5 metres south-west of its junction with Coltsfoot Place, continuing for a distance of approximately 9.5 metres in a south-westerly direction
- BP02 From a point approximately 11.5 metres south-west of its junction with Coltsfoot Place, continuing for a distance of approximately 9.5 metres in a south-westerly direction
- BP03 From a point approximately 60 metres north-east of its junction with Coltsfoot Place, continuing for a distance of approximately 9.5 metres in a north-easterly direction
- BP04 From a point approximately 77.5 metres north-east of its junction with Coltsfoot Place, continuing for a distance of approximately 9.5 metres in a north-easterly direction
- BP05 From a point approximately 12 metres south-west of its junction with Cranesbill Place, continuing for a distance of approximately 9 metres in a south-westerly direction
- BP06 From a point approximately 12 metres north-east of its junction with Cranesbill Place, continuing for a distance of approximately 9.5 metres in a north-easterly direction
- BP07 From a point approximately 26 metres north-east of its junction with Cranesbill Place, continuing for a distance of approximately 9.5 metres in a north-easterly direction

###### **CENTRAL RESERVATION, SOUTH-EAST SIDE**

- BP08 From a point approximately 25.5 metres south-west of its junction with Coltsfoot Place, continuing for a distance of approximately 9.5 metres in a south-westerly direction
- BP09 From a point approximately 11.5 metres south-west of its junction with Coltsfoot Place, continuing for a distance of approximately 9.5 metres in a south-westerly direction
- BP10 From a point approximately 60 metres north-east of its junction with Coltsfoot Place, continuing for a distance of approximately 9.5 metres in a north-easterly direction
- BP11 From a point approximately 77.5 metres north-east of its junction with Coltsfoot Place, continuing for a distance of approximately 9.5 metres in a north-easterly direction
- BP12 From a point approximately 12 metres south-west of its junction with Cranesbill Place, continuing for a distance of approximately 9 metres in a south-westerly direction
- BP13 From a point approximately 12 metres north-east of its junction with Cranesbill Place, continuing for a distance of approximately 9.5 metres in a north-easterly direction
- BP14 From a point approximately 26 metres north-east of its junction with Cranesbill Place, continuing for a distance of approximately 9.5 metres in a north-easterly direction

COLTSFOOT PLACE, CONNIBURROW  
CENTRAL RESERVATION, NORTH-EAST SIDE

- BP15 From a point approximately 12.5 metres south-east of its junction with Conniburrow Boulevard, continuing for a distance of approximately 9.5 metres in a south-easterly direction
- BP16 From a point approximately 27 metres south-east of its junction with Conniburrow Boulevard, continuing for a distance of approximately 9.5 metres in a south-easterly direction
- BP17 From a point approximately 25.5 metres north-west of its junction with Cleavers Avenue, continuing for a distance of approximately 9.5 metres in a north-westerly direction
- BP18 From a point approximately 11.5 metres north-west of its junction with Cleavers Avenue, continuing for a distance of approximately 9.5 metres in a north-westerly direction
- BP19 From a point approximately 12.5 metres south-east of its junction with Cleavers Avenue, continuing for a distance of approximately 9.5 metres in a south-easterly direction

CENTRAL RESERVATION, SOUTH-WEST SIDE

- BP20 From a point approximately 12.5 metres south-east of its junction with Conniburrow Boulevard, continuing for a distance of approximately 9.5 metres in a south-easterly direction
- BP21 From a point approximately 27 metres south-east of its junction with Conniburrow Boulevard, continuing for a distance of approximately 9.5 metres in a south-easterly direction
- BP22 From a point approximately 25.5 metres north-west of its junction with Cleavers Avenue, continuing for a distance of approximately 9.5 metres in a north-westerly direction
- BP23 From a point approximately 11.5 metres north-west of its junction with Cleavers Avenue, continuing for a distance of approximately 9.5 metres in a north-westerly direction
- BP24 From a point approximately 12.5 metres south-east of its junction with Cleavers Avenue, continuing for a distance of approximately 9.5 metres in a south-easterly direction

CRANESBILL PLACE, CONNIBURROW  
CENTRAL RESERVATION, NORTH-EAST SIDE

- BP25 From a point approximately 12.5 metres south-east of its junction with Conniburrow Boulevard, continuing for a distance of approximately 9.5 metres in a south-easterly direction
- BP26 From a point approximately 26.5 metres south-east of its junction with Conniburrow Boulevard, continuing for a distance of approximately 9.5 metres in a south-easterly direction
- BP27 From a point approximately 26 metres north-west of its junction with Cleavers Avenue, continuing for a distance of approximately 9.5 metres in a north-westerly direction
- BP28 From a point approximately 12 metres north-west of its junction with Cleavers Avenue, continuing for a distance of approximately 9.5 metres in a north-westerly direction
- BP29 From a point approximately 12 metres south-east of its junction with Cleavers Avenue, continuing for a distance of approximately 9.5 metres in a south-easterly direction

#### CENTRAL RESERVATION, SOUTH-WEST SIDE

- BP31 From a point approximately 12.5 metres south-east of its junction with Conniburrow Boulevard, continuing for a distance of approximately 9.5 metres in a south-easterly direction
- BP32 From a point approximately 26.5 metres south-east of its junction with Conniburrow Boulevard, continuing for a distance of approximately 9.5 metres in a south-easterly direction
- BP33 From a point approximately 26 metres north-west of its junction with Cleavers Avenue, continuing for a distance of approximately 9.5 metres in a north-westerly direction
- BP34 From a point approximately 12 metres north-west of its junction with Cleavers Avenue, continuing for a distance of approximately 9.5 metres in a north-westerly direction
- BP35 From a point approximately 12 metres south-east of its junction with Cleavers Avenue, continuing for a distance of approximately 9.5 metres in a south-easterly direction
- BP36 From a point approximately 25.5 metres south-east of its junction with Cleavers Avenue, continuing for a distance of approximately 9.5 metres in a south-easterly direction

#### RAMSONS AVENUE, CONNIBURROW

##### CENTRAL RESERVATION

- BP37 From a point approximately 18.5 metres north-east of its junction with Mallow Gate, continuing for a distance of approximately 15.5 metres in a north-easterly direction
- BP38 From a point approximately 7.5 metres south-west of its junction with Stonecrop Place, continuing for a distance of approximately 15.5 metres in a south-westerly direction
- BP39 From a point approximately 25 metres north-east of its junction with Stonecrop Place, continuing for a distance of approximately 15.5 metres in a north-easterly direction
- BP40 From a point approximately 25 metres south-west of its junction with Speedwell Place, continuing for a distance of approximately 15.5 metres in a south-westerly direction
- BP41 From a point approximately 25 metres north-east of its junction with Speedwell Place, continuing for a distance of approximately 15.5 metres in a north-easterly direction
- BP42 From a point approximately 56 metres north-east of its junction with Speedwell Place, continuing for a distance of approximately 15.5 metres in a north-easterly direction
- BP43 From a point approximately 55.5 metres south-west of its junction with Yarrow Place, continuing for a distance of approximately 16 metres in a south-westerly direction
- BP44 From a point approximately 24.5 metres south-west of its junction with Yarrow Place, continuing for a distance of approximately 16 metres in a south-westerly direction

#### SPEEDWELL PLACE, CONNIBURROW

##### CENTRAL RESERVATION

- BP45 From a point approximately 25 metres south-east of its junction with Conniburrow Boulevard, continuing for a distance of approximately 15.5 metres in a south-easterly direction

BP46 From a point approximately 24.5 metres north-west of its junction with Cleavers Avenue, continuing for a distance of approximately 15.5 metres in a north-westerly direction

BP47 From a point approximately 24.5 metres south-east of its junction with Cleavers Avenue, continuing for a distance of approximately 11.5 metres in a south-easterly direction

**STONECROP PLACE, CONNIBURROW  
CENTRAL RESERVATION**

BP48 From a point approximately 25 metres south-east of its junction with Conniburrow Boulevard, continuing for a distance of approximately 16 metres in a south-easterly direction

BP49 From a point approximately 24.5 metres north-west of its junction with Cleavers Avenue, continuing for a distance of approximately 16 metres in a north-westerly direction

BP50 From a point approximately 7.5 metres south-east of its junction with Cleavers Avenue, continuing for a distance of approximately 16 metres in a south-easterly direction

**YARROW PLACE, CONNIBURROW  
CENTRAL RESERVATION**

BP51 From a point approximately 25 metres south-east of its junction with Conniburrow Boulevard, continuing for a distance of approximately 15.5 metres in a south-easterly direction

BP52 From a point approximately 25 metres north-west of its junction with Cleavers Avenue, continuing for a distance of approximately 15.5 metres in a north-westerly direction

BP53 From a point approximately 24.5 metres south-east of its junction with Cleavers Avenue, continuing for a distance of approximately 11.5 metres in a south-easterly direction

**SCHEDULE 3B**

**BUSINESS PROPERTIES OR ORGANISATIONS WHICH ARE ELIGIBLE  
TO APPLY FOR BUSINESS PERMITS**

Conniburrow Boulevard, Conniburrow Numbers 198, 200, 258 and 330

Ramsons Avenue, Conniburrow

Numbers: 29, 30, 31, 32, 90, 96, 93, 153, 154, 159, 160 and The Salvation Army

**SCHEDULE 4**

**PERMIT CHARGES**

	PERMIT	PERIOD	CHARGE
1.	Resident's permit PERMIT FOR PLACES SPECIFIED IN SCHEDULE 2A	12 MONTHS	FREE



2.	<b>Resident's Visitor's Permit PERMIT FOR PLACES SPECIFIED IN SCHEDULE 2A</b>	<b>12 MONTHS</b>	<b>FREE</b>
3.	<b>Carer's Permit PERMIT FOR PLACES SPECIFIED IN SCHEDULE 2A</b>	<b>12 MONTHS</b>	<b>FREE</b>
4.	<b>Business Permit PERMIT FOR PLACES SPECIFIED IN SCHEDULE 3A</b>	<b>12 MONTHS</b>	<b>FREE</b>
5.	<b>Replacement Permit</b>	<b>For the unused amount of time for which the original permit was valid</b>	<b>FREE</b>

THE COMMON SEAL OF the COUNCIL OF  
THE BOROUGH OF MILTON KEYNES was  
hereunto affixed this 5<sup>th</sup> day of September 2012  
in the presence of:-

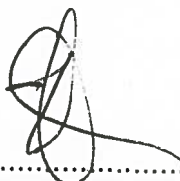

.....  
ACTING ASSISTANT DIRECTOR – LAW & GOVERNANCE

